

phréatiques

portfolio 2010-2011



Julien Bruneau

in collaboration with

Maya Dalinsky,
Laure Myers,

Nada Gambier,
Jeroen Peeters,

Anouk Llaurens,
Sonia Si Ahmed.

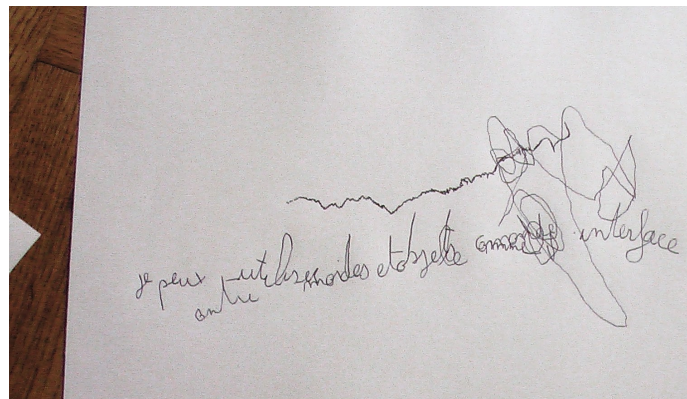

phréatiques works on combinations of dance, drawing and verbal thinking with a collective approach.



sensing-thinking drawing 4, 2010, graphite on paper, 100x180cm

Made by three people drawing simultaneously, eyes closed. The drawing is the trace of gestures triggered by a tactile exploration of a "still life".

While drawing and sensing, drawers reflect verbally on their personal and collective experience. Statements out of this line of thoughts are written on the drawing.

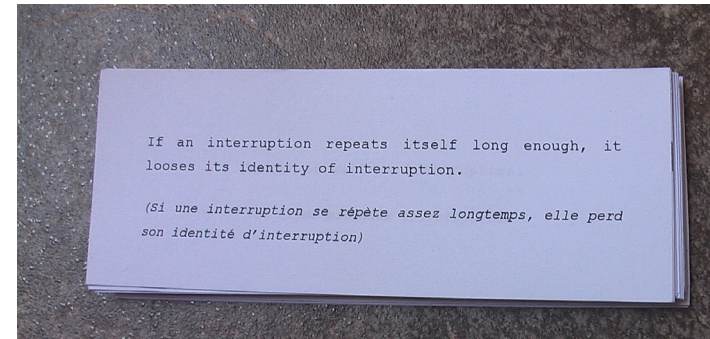

sensing-thinking drawing 4

Left : detail / Right : Underneath the drawing, a pile of small papers lies on the floor. They are for the visitors to take with them. There are three different papers, each showing one of the statements written somewhere on the drawing.

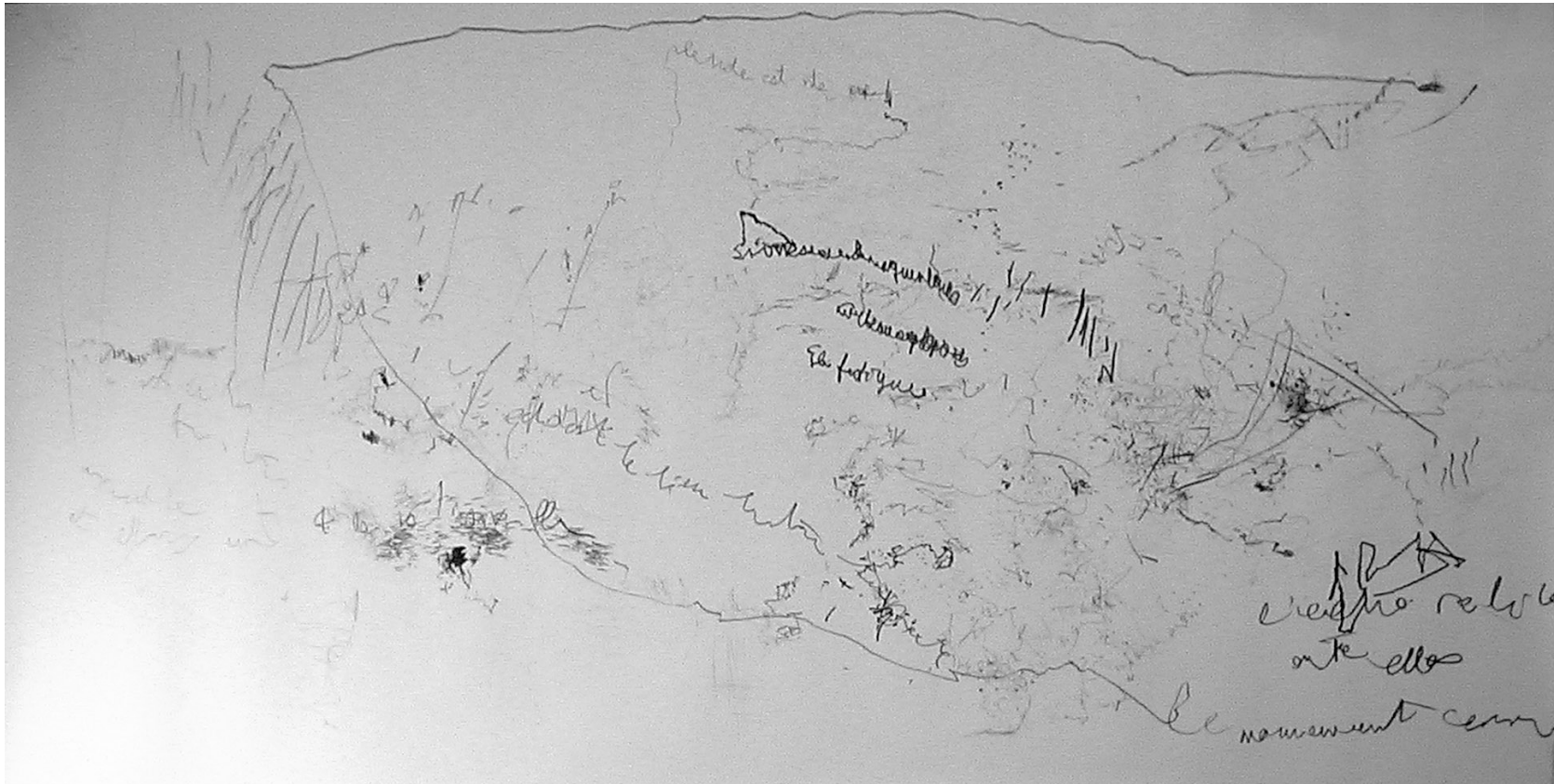

sensing-thinking drawing 2, 2010, graphite on paper, 100x180cm



sensing-thinking drawing 3, 2010, graphite on paper, 100x180cm



Magnitudes exhibition, at Twilight Zone Art Gallery (Tournai - B), 2011 :
sensing-thinking drawing 4 (left) and **self-portrait** series (right) mixed with Mélanie Berger's drawings.



self-portrait series : **Jeroen 14/05/2011** and **Anouk 18/09/2010**, ballpen on paper, 21x28,2cm each.

Individual drawings, made eyes-closed, and focused either on touch, or hearing, or kinesthesia... (depending the case).



self-portrait series : **Laure 20/09/2010** and **Sonia 16/05/2010**, ballpen on paper, 21x28,2cm each

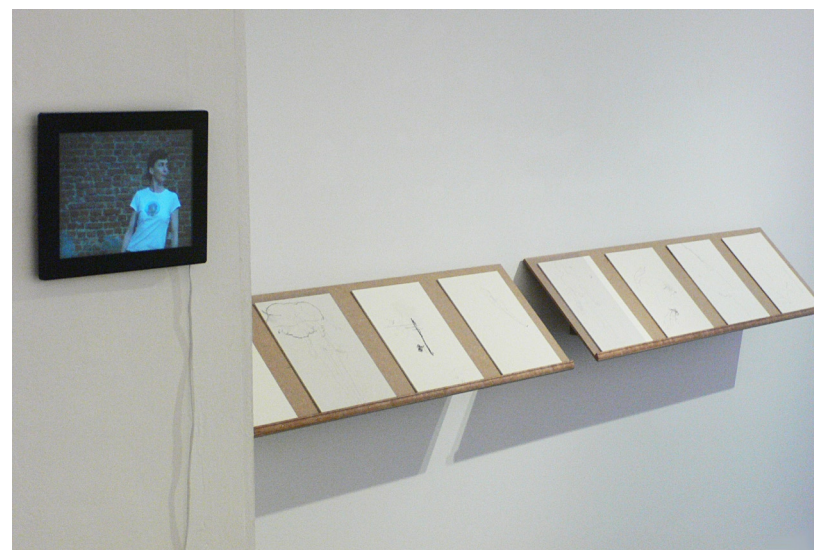

Magnitudes exhibition, at Twilight Zone Art Gallery (Tournai - B), 2011 :
partitions 1-8 and **meta-instrument score (September 2011)** video.

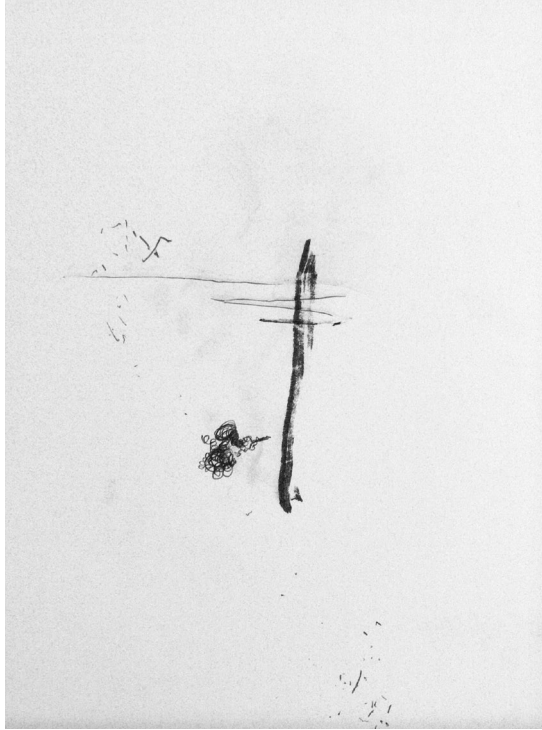

partition 3, 7 & 8, 2010-11, ballpen on paper, 21x28,2cm

Each drawing is done by several people. The mode of composition is inspired by choreographic principles.

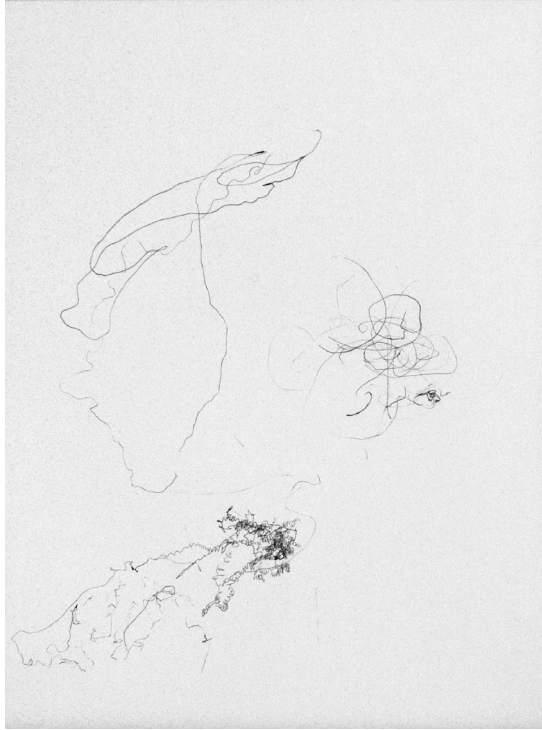

partition 6, 2011, ballpen on paper, 21x28,2cm

When a transparent body silhouette is added on any of those drawings, it becomes a partition for a dance.

See meta-instrument score (Septembre 2011) : <http://vimeo.com/33391683>

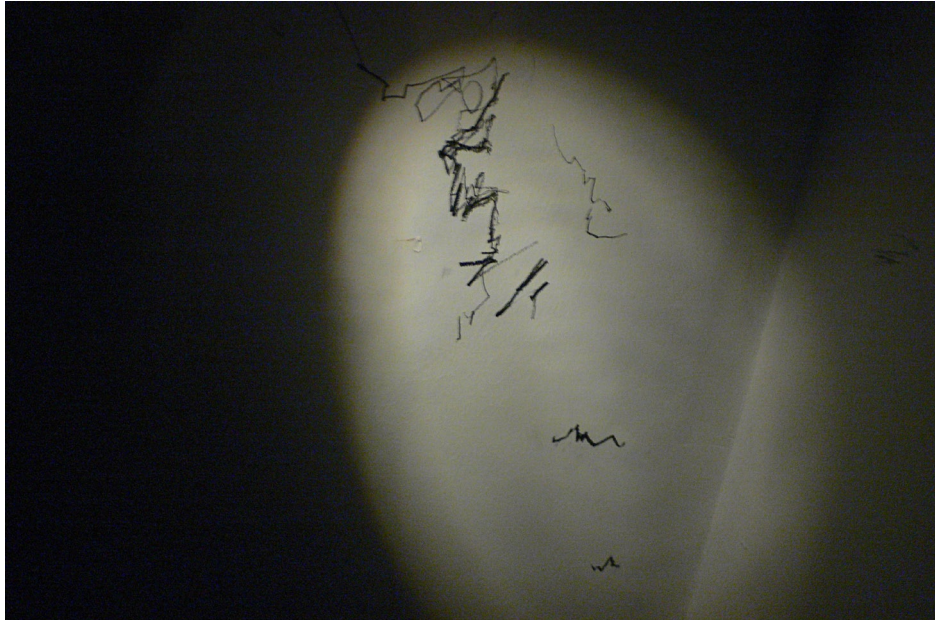

50N 36' 32.076"/ 3E 23' 9.6684", 02-11-2011, 14h10-15h10, 2011, graphite on walls, audio recording on cd, discman, torch light

Work in situ, in a very small room where only one visitor at a time could stand. There is no light except for a small LED torch light one gets before to enter. The drawing is made of scarce traces and writings spread over the walls, ceiling and floor, waiting to be discovered bit by bit. A discman in the room provide an edited audio recording of the thinking process that has happened simultaneously to the process of drawing (see **sensing-thinking drawing 1**)

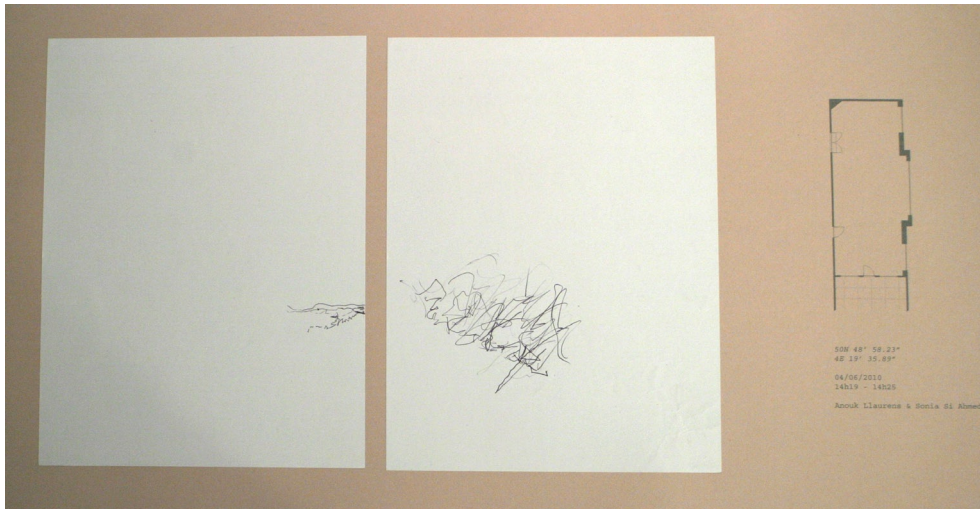

single image replay 04/06/2010 - 1 & 3, 2010, ballpen and inkjet on paper, 35x71cm

Drawings made both as notation and partition of performative acts focused on making visible the place where the score is being played.
(*"single image" and "replay" are notions and practices borrowed to the American artist Lisa Nelson*).



Magnitudes exhibition, at Twilight Zone Art Gallery (Tournai - B), 2011:
single image replay 04/06/2010 - 1 & 3 (on the wall, works of Mélanie Berger)

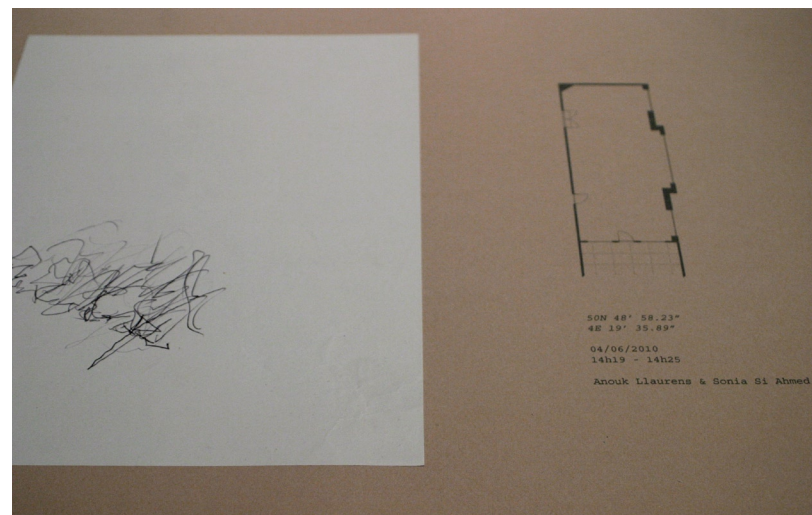

single image replay 04/06/2010 - 1 (*detail*)

biography

Julien Bruneau (B) is based in Belgium where he first studied visual art at La Cambre (Bruxelles). His artistic research led him towards dance, the field where he mainly developed his activity since then. For several years, he creates his own work, collaborating with people involved in various disciplines - dance, music, visual arts, photography, performed poetry or philosophy - for set pieces, improvisation projects, and researches (with Maurizio Saiu, Phonotopy, Hugues Warin, Idioms Film collective, Antoine Boute, Alix de Morant, Jonathan Philippe ...).

His work (*centaure : une flaque animale de miel brun (avec des poils dedans), vrac pli, oint.oint., v a s t e, seconde main, caballeros*) has been supported / produced by / performed at a.o. Les Halles de Schaerbeek (B), Roma Europa festival (IT), Bains Connective, de Pianofabriek, Netwerk, La Maison Folie de Mons (B), Dock 11 (D), Point Ephémère (FR).

In Spring 2010, he initiated the ongoing research project *phréatiques* that experiments diverse combinations of dance, drawing and verbal thinking through a collective approach (with Sonia Si Ahmed, Laure Myers, Anouk Llaurens, Nada Gambier, Maya Dalinsky and Jeroen Peeters). It has been / will be supported by Bains Connective, Summer Studio, Vooruit, Workspacebrussels, Sarma, Wp Zimmer, Netwerk (B). In 2011, drawings of the process were part of an exhibition at Gallery Twilight Zone Tournai in the frame of WTS, by Réseau 50° Nord. The works goes on in 2012 through residencies, showings and an on-line publication on Sarma's Oral Site.

As a performer for other's pieces, Julien Bruneau worked notably for the theatre director Claude Schmitz and with the choreographers Christine Quoiraud, Stefan Dreher, Lilia Mestre and Anouk Llaurens. Beside his activities as dancer / choreographer, he develops as well a practice of drawing and writing.

He is currently part of the Amsterdam Master of Choreography program (Theatreschool).

bruneaujulien66@gmail.com

+32 497 638 428

skype : bruneau.julien